

Crawford County line

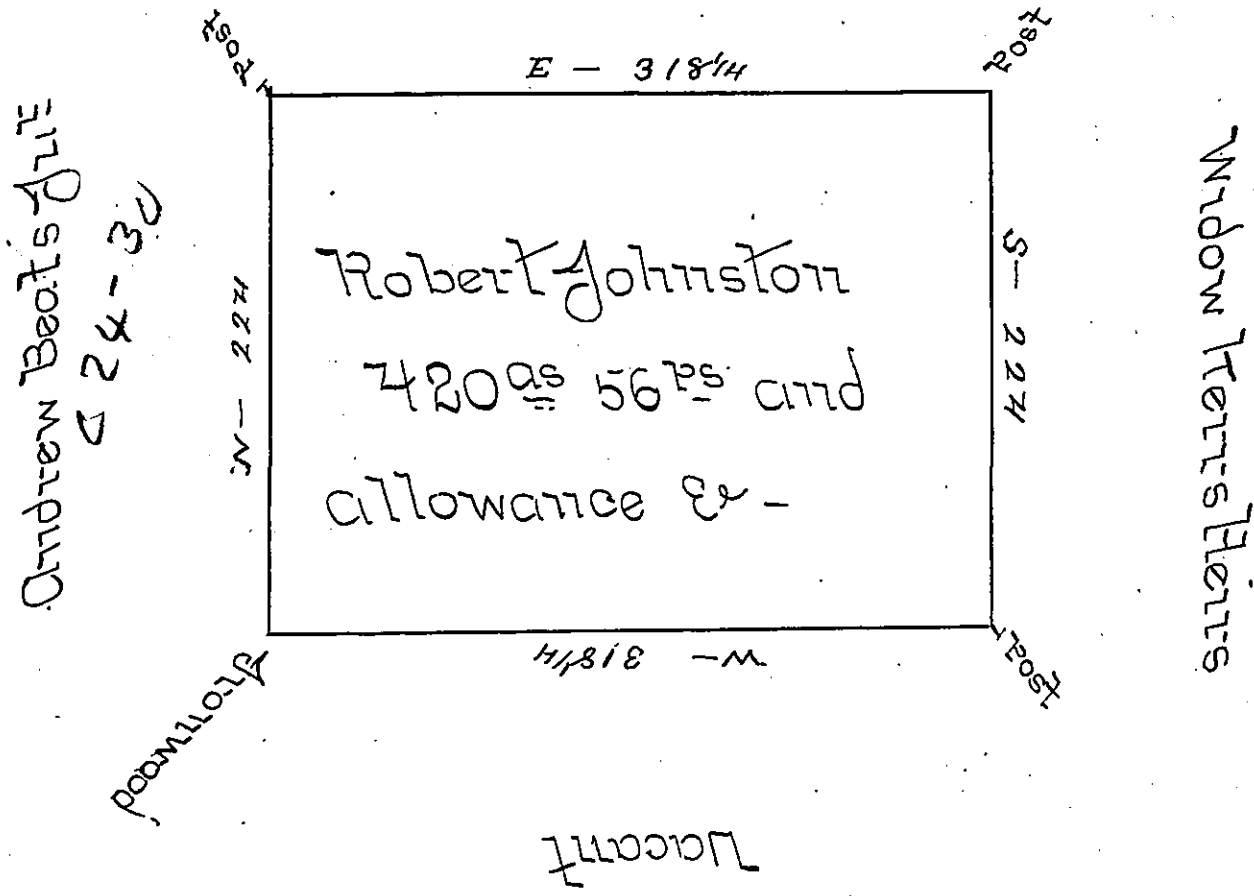

A tract of 420^{as} 56^{ps} and allowance situated in West Salem Township Mercer County and on the Waters of Big Sherrango Surveyed March 8th 1821 to Robert Johnston in pursuance of his actual settlement and improvement on the same

Allen Dunn D.S.

To Jacob Spangler Esq
Surveyor General -

Improvement are two Cabbins a double barn and about 40 acres cleared fenced and Cultivated

A. Dunn D.S.

IN TESTIMONY that the above is a copy of the original remaining on file in the Department of Internal Affairs of Pennsylvania, made conformably to an Act of Assembly approved the 16th day of February, 1833, I have hereunto set my Hand and caused the Seal of said Department to be affixed at Harrisburg, this first day of November 1898.

James W. Fetter
Secretary of Internal Affairs.